

VIVOSUN



Inline Duct Fan USER MANUAL

Love what you grow™

Welcome to **VIVOSUN**

Thank you for choosing VIVOSUN. We are committed to product quality and friendly customer service. If you have any questions or suggestions, please don't hesitate to contact us.

CONTENTS

Product Information	1
Product Contents	3
Series	4
Installation Instructions	5
Maintenance and Cleaning	6
Requirements	6
Warnings	7

PRODUCT INFORMATION

Our Inline Duct Fan is specifically designed for easy installation, compatibility and efficiency.

1. We designed the inlet and outlet openings to be the same size, eliminating the need for complicated ducting arrangements and installation.
2. The impeller is aerodynamically designed to reduce vibration and noise while generating ample power.
3. The Inline Duct Fan is lightweight enough to be easily installed by one person. It is available in three sizes, weighing from 8 lbs. (3.6 kg) to 13 lbs. (5.9 kg).
4. All materials used comply with RoHS (Restriction of Hazardous Substances) standards.
5. Our Inline Duct Fan can be installed in a wide variety of places, including hotels, grow rooms, supermarkets, storage areas, and bathrooms.

PRODUCT INFORMATION

The major components of our Inline duct fan are the casing (shell), impeller, motor, base, and electrical junction box (junction box).

1. **Shell:** Made of high-quality galvanized steel, the shell is highly resistant to atmospheric corrosion. The highly-efficient design allows unobstructed air flow and facilitates installation.
2. **Impeller:** The uniquely shaped plastic impeller delivers an outstanding performance in combination with the shell. The result is stronger airflow, impressive energy efficiency, and low noise levels.
3. **Motor:** The CCC-, CE- and UL-certified motor is designed to save space, reduce noise and vibration, and conserve energy. The motor features three speeds as well as an automatic reset function to protect against overheating.
4. **Junction box:** The electrical junction box, made of ABS and flame-retardant components, is designed for safety and fire prevention.

PRODUCT CONTENTS

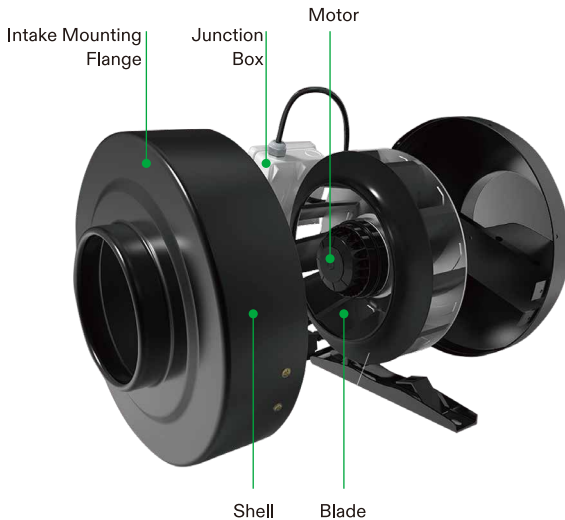

SERIES

Size	D	D1	L	L1	L2	F
Size	Φ4.0	Φ9.2	7.6	1.0	1.0	1.6
Size	Φ6.0	Φ10.8	7.6	1.0	1.0	1.6
Size	Φ8.0	Φ13.0	8.2	1.0	1.0	1.6

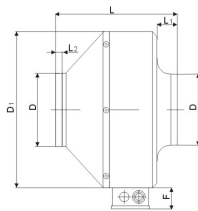

NOTES

1. After removing the inline duct fan from its packaging please, inspect the exterior and components of the fan to ensure that it has not been damaged in transit.
2. The Inline Duct Fan should only be operated within its electrical current and voltage ratings.
3. Please wear protective gloves or take similar precautions to prevent accidents when moving or installing the fan.
4. Please turn off the power before cleaning or performing maintenance.
5. Please do not expose the fan to sunlight, rain, snow, or other harsh conditions.
6. Please make sure that the fan is not turned on when installing the device.
7. Please store and install the fan out of the reach of young children to ensure safety.
8. Please keep the fan away from alcohol, gasoline, corrosive chemicals, and flammable or explosive compounds to prevent fire.

INSTALLATION INSTRUCTIONS

Please install the inline fan according to the installation diagrams.

1. When installing or transporting the inline fan, do not damage the blades or allow them to be deformed in any way.
2. Use a filter on the suction shaft to filter out oil and other particles.
3. Make sure to leave an 18x18 mm (0.7x0.7") hole for easy inspection and maintenance when installing the inline fan on the ceiling.
4. The inline fan can be installed on the floor, ceiling, or wall. Please install it on a solid surface and never on an unstable surface such as gypsum board/drywall.
5. Always use the mounting bracket as well as proper nuts and bolts to install the inline fan.

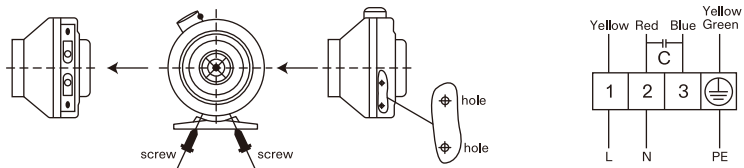

MAINTENANCE AND CLEANING

1. The motor and rotor blade of the Inline Duct Fan should be inspected every 6 months.
2. Fan maintenance should be performed by competent personnel only.
3. Turn off the power when cleaning or repairing the fan. After cleaning or repair, check the integrity of the fan and ensure all components are properly installed before turning on the device.

REQUIREMENTS

1. Operating temperature and humidity
Operating temperatures: -40°C/-104°F to+65°C/+149°F
Operating humidity: 5% to 95% RH
2. Presence of electrically conductive air particles: The air in the operating area should be free of significant concentrations of electrically conductive particles such as activated carbon, ferrous powders, etc.
3. Storage temperature and humidity
Storage temperatures: -40°C/-1049°F to+65°C/+149°F
Storage humidity: 0% to 85%RH

Please read the following warnings carefully before using this product for the first time.

Failure to comply with these safety warnings may result in serious injury or accidents and will release VIVOSUN of all liability and void all product warranties.

WARNINGS

1. The fan and motor must be operated only within the specified temperature range (-40°C/-104°F to +65°C/+ 149°F) and humidity range (5% to 95%RH), otherwise the device may cause electric shock to users or unexpected damage.
2. The fan should not be operated in environment where there is a significant concentration of electrically conductive particles, such as activated carbon or ferrous powders in the air.
3. Use the correct voltage according to the nameplate, otherwise the product will be damaged.
4. Follow the wiring diagram for installation and ensure the device is connected to the ground if required. Use of an extension cord is not recommended. Improper connection may cause damage to the fan.
5. Exercise caution when moving the fan. Do not lift or carry the fan by its blades, as this may cause the device to make more noise during operation.
6. The length of the mounting screws must not exceed the specified length, otherwise the fan will be damaged.
7. Do not remove any components of the device, as this may affect the fan's safe operation, air-tightness, balance, or other important properties.
8. The overcurrent protector is necessary to prevent damage from overcurrent.
9. Install the fan only as indicated in the user manual. Any other method of installation may affect its service life.
10. Keep the fan, especially its blades and electrical components, should be kept out of the reach of children. Children should not operate the fan without adult supervision.

Designed by **VIVOSUN** in California.
Made in China