

# Adjustable Seedling Heat Mat

## USER MANUAL

# Love what you grow™

Welcome to **VIVOSUN**

Thank you for choosing VIVOSUN. We are committed to product quality and friendly customer service. If you have any questions or suggestions, please don't hesitate to contact us.



**PRODUCTS INCLUDED IN THIS MANUAL:**

Product	Model	SKU
Heat Mat 10" x 20.75"	VSS-HM01-CT	330301
Heat Mat 20" x 20.75"	VSS-HM02-CT	330302
Heat Mat 48" x 20.75"	VSS-HM03-CT	330303

# CONTENTS

Safety Information .....	1
Key Features .....	2
Product Contents .....	3
Specifications .....	4
Installation .....	5
Warranty Information .....	7

# SAFETY INFORMATION



Please read the following information carefully before using. Failure to observe these safety instructions may result in serious injury and will release VIVOSUN of all liability and void all product warranties.

1. The input voltage is 120V AC/60Hz. DO NOT use this product under higher input voltages.
2. DO NOT use the product outdoors or in any hazardous locations such as places near flammable, explosive, corrosive chemicals.
3. Make sure the surface under the mat is free of sharp objects which may damage the mat.
4. DO NOT place the mat inside the propagation tray or cover it directly with soil or any other growing medium.
5. DO NOT touch the heat mat surface when it is working, keep away from children.
6. DO NOT use this product in the water or any other liquid.
7. DO NOT place any heat insulating materials over the mat which may cause it to overheat.
8. DO NOT cover the power cords with rugs or other fabric materials.
9. Unplug and shut off the power before installing, maintaining, moving or any water leaks detected.
10. If your device or power cord is damaged, stop using and contact us for service. Disassemble or modify devices without VIVOSUN permission may cause damage and void warranty.

# KEY FEATURES

## TEMPERATURE CONTROL

Precise temperature control with setting range of 34°F- 122°F.

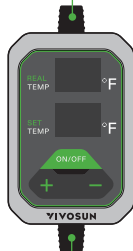

## TEMPERATURE DISPLAY

Real-time temperature display helps you monitor status.

## BUILT-IN SENSOR

Built-in sensor precisely measures temperatures of the heat mat for reliable heat control.

## EVEN HEATING

Provide even heat on the mat area to ensure the healthy and uniform seedling.

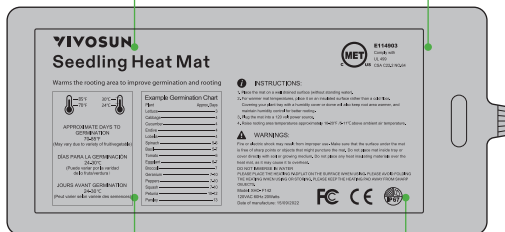

## SPILL RESISTANT

Made with water-resistant material relieves any worry about safety while using the device.

## EASY TO USE

Plug in and use immediately with intuitive controls.

# PRODUCT CONTENTS

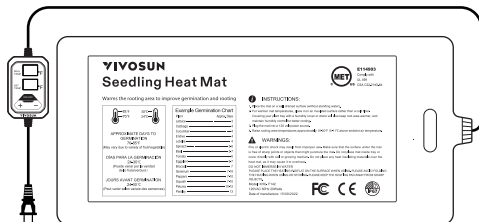

Adjustable Seedling Heat Mat  
x 1pc

# SPECIFICATIONS

SKU	330301	330302	330303
Input Power	20W $\pm$ 10%	40W $\pm$ 10%	105W $\pm$ 10%
Input Voltage	120V AC		
Frequency	60Hz		
Mat Size	10" x 20.75"	20" x 20.75"	48" x 20.75"
Temperature Set	34°F- 122°F (30°C-50°C) *		
Insulation Resistance	$\geq$ 100M $\Omega$ /500Vdc		
Service Lifetime	$\geq$ 30000 Hours		

\* The maximum working temperature of the mat is 77°F (25°C) higher than the ambient temperature, but never exceeds 122°F (50°C).

# INSTALLATION

## STEP 1

Unfold and place the heat mat on a flat and stable dry surface. Then put your propagation tray on it.

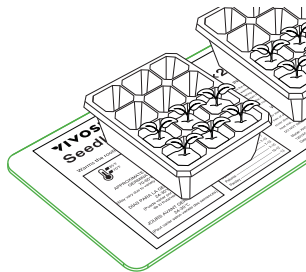

## STEP 2

Plug the power cord into nearby 120V AC outlet.

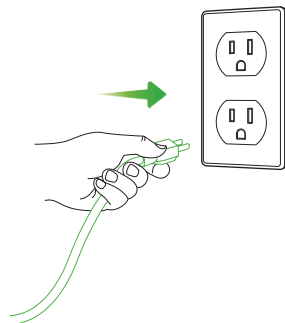

# INSTALLATION

## STEP 3

Turn on the heat mat by pressing the **ON/OFF** button and the mat will start heating with the default temperature setting of 95°F.

Press the **+ -** button to set the target temperature. The **SET TEMP** displays the setting temperature and the **REAL TEMP** displays the current temperature.

Please see the suggested settings for different plants on the heat mat.

**Note:** The screens will turn off automatically if no operation is performed for a while. Press the + or - to turn on the screen again to check status and change the setting.

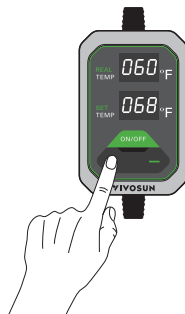

## STEP 4

Turn off the heat mat by press the **ON/OFF** button and it will stop heating or maintaining the temperature.

**Note:** Press the **ON/OFF** button to turn off will not lose the current setting. Unplug the power cord or power outage will lose the current setting.





# WARRANTY INFORMATION

1. We offer a 1-year warranty against manufacturing defects for all of our products from the date of purchase. If you need warranty assistance, please contact us as soon as possible.
2. The warranty does not cover damage due to high moisture levels, water damage, power surges, improper hanging/mounting, improper use, dust build-up, or users' unauthorized modifications.
3. In the USA, if any heat mat ceases working within 30 days of use, you can choose:
  - (A) Exchange: We will email you a pre-paid return label. Please ship the product back to our USA warranty center and a replacement will be sent to you free of charge as soon as we receive the defective product.
  - (B) Refund: We will email you a pre-paid return label. Please ship the product to our USA warranty center and we will issue a refund as soon as the product has been received. Refund periods may depend on the processing time of your bank or institution—usually, a refund takes about 5 business days to be processed.
4. Our company reserves all rights to the final explanation of this warranty structure. If you have any questions about our warranty policy, please contact us.

Designed by **VIVOSUN** in California.  
Made in China