

CALIBRATION

EC/TDS

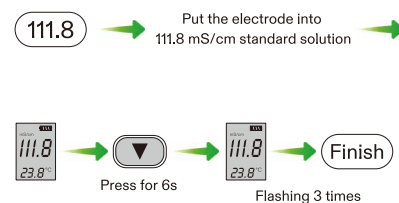

LOW BATTERY

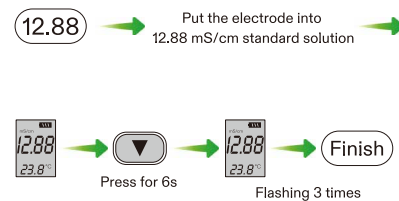
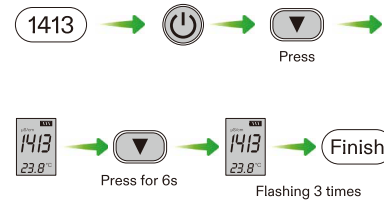
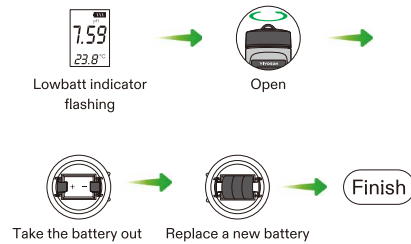

ELECTRODE

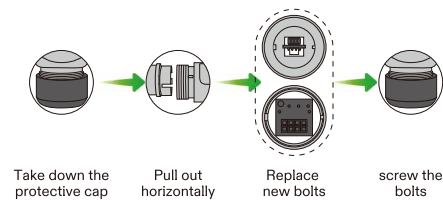

TROUBLESHOOTING

RESETTING PH

1. Turn off the meter, press HOLD/TEMP and MODE/CAL simultaneously, don't release;
2. Press ON/OFF, and release all buttons, the reset is complete.

ATTENTION

1. About TDS Testing: The Instrument had been calibrated by the manufacturer in advance. You can use it to test TDS value directly, without going through the steps to calibrate the device. This device features an auto-calibration function so you are free from TDS calibration trouble for 1 year.
2. If you want to purchase additional TDS calibration solution after one year, please contact VIVOSUN customer service.
3. After you have finished, clean the electrode with clean, distilled water and keep it dry.
4. Stir gently several times to ensure there are no air bubbles around the electrode.
5. Do not disassemble the meter without permission to avoid damage.
6. If pH calibration is incorrect, please reset the device.
7. When testing purified water like spring water or drinking water, it will take longer for the readings to stabilize (typically 3-5 minutes) because there are very few ions left for the sensor to detect in purified water.



- Please note that some parts of the instrument are not waterproof. DO NOT submerge the instrument in water higher than the immersion line, or the instrument will be defective.

WARRANTY

We warrant this unit to be free from defects in material and workmanship and agree to repair or replace free of charge, at VIVOSUN's option, any defective or malfunctioning product for which VIVOSUN is responsible, free of charge, for a period of ONE YEAR.

This limited warranty does not cover damage caused by transportation, storage, improper use, failure to follow the product instructions or failure to perform any preventive maintenance, modification, combination or use with any product, material, process, system or other matter not furnished or approved in writing by us, unauthorized repair, normal wear and tear, or external causes such as accidents, misuse, or other actions or events beyond our reasonable control.

VIVOSUN



4-in-1 PH Meter USER MANUAL



Welcome to VIVOSUN

Thank you for choosing VIVOSUN. We are committed to product quality and friendly customer service. If you have any questions or suggestions, please don't hesitate to contact us.

CONTENTS

Startup Screen Display	1
Buttons	1
Operation	1
Parameter	2
Calibration	4
Low Battery	6
Electrode	6
Troubleshooting	6
Attention	7
Warranty	8

STARTUP SCREEN DISPLAY

- Hold and Battery Indicator
- Testing Values
- ppm/ppt
- uS/cm and mS/cm
- %
- pH
- °C/°F
- S.G
- mV

BUTTONS

- Power Button
- HOLD/TEMP Hold and Temperature shift button
- MODE/CAL Mode and Calibration shift button
- Adjust values up/down in calibration mode

OPERATION

HOLD/TEMP.SHIFT

Long Press HOLD/TEMP Temperature Conversion

OPERATION

MODE SHIFT

PARAMETER

Item	4-IN-1 DIGITAL WATER QUALITY METER	
EC	Range	1-9990 μs/cm
	Resolution	1 μs/cm
	Accuracy	±2% FS
TDS	Range	1-9990 ppm
	Resolution	1 ppm
	Accuracy	±2% FS
Temperature	Range	0-60°C (32-140°F)
	Resolution	1°C
	Accuracy	±2°C
PH	Range	0.00-14.00 pH
	Resolution	0.01 pH
	Accuracy	±0.05 pH

PARAMETER

Item	4-IN-1 DIGITAL WATER QUALITY METER	
Calibration	EC	Automatic solution detection (1413μs/cm, 12.88mS/cm, 111.8mS/cm). If the meter is unable to detect the solution, change the electrode or contact the supplier.
	PH	One point, two points or three points automatically. If the meter is unable to detect the solution, change the electrode or contact the supplier.
Waterproof Level	IP65 (Do NOT immerse the item into water higher than electrode line)	
Temperature	ATC 0-60°C	
Operation Environment	0-60°C (32-140°F); RH 100%	
TDS Factor	0.5	
Temperature Range	0-60°C (32-140°F)	
Temperature Accuracy	±0.5	
Temperature Resolution	1°C/°F	
Automatic Shut-off	Approximately 5 minutes	
Battery	3*1.5V (LR44)	
Screen Size	33*24mm	
Dimension Weight	183*37*37mm (7.2*1.5*1.5in)/90g (3.2oz)	
Display	LCD digital display	
Backlight	Green backlit	
Attention	Clean the electrode after use	

CALIBRATION

PH

Press MODE/CAL

Press for 6s MODE/CAL Flashing 3 times Finish

Put the electrode into pH 4.00 standard solution

Press for 6s MODE/CAL Flashing 3 times Finish

Put the electrode into pH 9.18 standard solution

Press for 6s MODE/CAL Flashing 3 times Finish